

Series 200 Butterfly Valves

Advanced Angle-disc Design:

Provides bi-directional, positive shutoff and long service life.



Series
R200



Series
M200

Norris Series 200 butterfly valves provide bi-directional, positive shutoff to 200 psig working pressure. They are available in both resilient-seated (Series R200) and metal-lined (Series M200) configurations. All Series 200 butterfly valves feature a unique, angle disc that creates a 360° uninterrupted differential sealing surface.

Series 200 butterfly valves have double-shaft seals and body bushings to assure smooth, low-torque operation. They are available with a full range of pneumatic, electric and hydraulic actuation.

Series 200 butterfly valves have independent flange seals and a non-wetted body that may be specified with either lug or wafer design.

All Series 200 butterfly valves are easily repaired in the field.

Features

- Double-shaft seals and body bushings assure smooth, low-torque operation
- Independent flange seals
- Rigid-backed rubber seat easily field-replaced
- Non-wetted body available in lug or wafer designs
- Rigid drive, precision disc-to-shaft connection
- Resilient-seated design (R200) offered in a wide variety of elastomeric seals and metallic materials
- Metal-lined design (M200) provides positive shutoff with minimum sealing material
- Available with a variety of pneumatic, electric and hydraulic actuation

Contents

- 2** When to Use R200
- 3** R200 Parts Description
- 4** When to Use M200
- 5** M200 Parts Description
- 6** R&M-1000 Dimensions
- 8** R&M-3000 Dimensions
- 10** Series 200 Model Code
- 11** Series 200 Specifications

NORRIS
PRODUCTION SOLUTIONS

A DOVER COMPANY

NORRISSEAL™
A DOVER COMPANY

**Engineered
Performance**

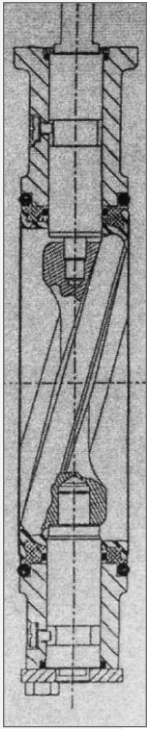

When to use Series R-200 Valves

- **Use R-Series valves for positive shutoff to 200 psi wp.**
Under certain service conditions, Norris valves may be rated up to 250 psi wp. Consult factory for trim recommendations and pricing.
- **Use R-Series valves for throttling control at flow rates up to 30 fps.**
- **Use R-Series valves at temperatures from -20° to +250°F.**

Proper selection of seal elastomers must be made for valve applications at extreme temperatures.

- **Use R-Series valves for bi-directional flow conditions.**
- **Use R-Series valves for controlling the flow of liquids, gases and solids, including abrasive and corrosive materials.**

R-Series valves are not recommended for handling gasoline and other volatile media. Volatile materials or solvents tend to dry out elastomers and make the valves difficult to operate. See M-Series section of catalog for gasoline service. Rubber liner and double o-ring shaft seals prevent line media from contacting body of valve, making use of premium body materials unnecessary. Only the internal wetted parts need to be corrosion resistant to the media.

- **Use R-Series valves for end-of-line suspension to full rated working pressure by temporarily installing a downstream flange or spool piece.**

With the downstream flange removed, R-series valves are derated for safety to 75 psi wp.

- **Use R-Series valves for insulated lines.**

14 inch and larger Norris valves will accommodate 2 inches of insulation on accompanying pipelines. A neck extender is available for use with 2 thru 12 inch wafer valves when lines are insulated.

- **Use R-Series valves with ANSI Class 125 cast iron or Class 150 steel flanges.**

Well neck or socket weld flanges are recommended for use with R-Series valves to provide support for the seat and to assure optimum performance at the full rated pressure of the valve. R-Series span type valves can be used with

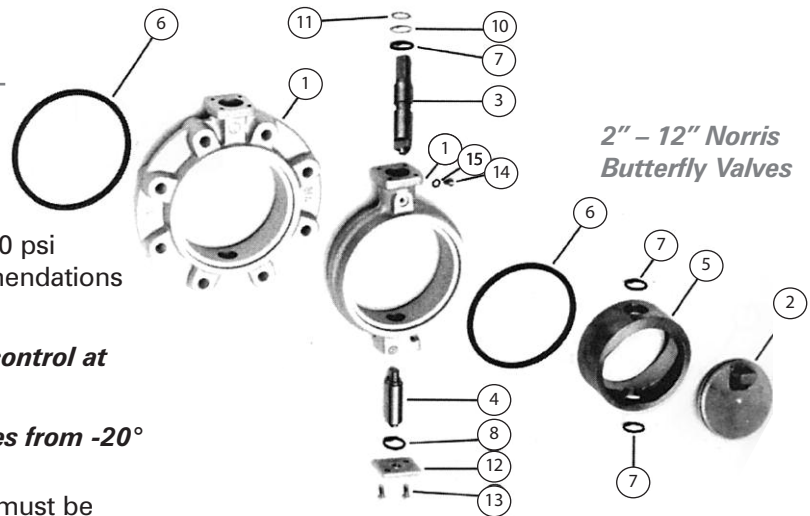

2" – 12" Norris Butterfly Valves

ANSI Class 300 flanges; However, some valve sizes may require special bolt drilling or spacers. Lug style bodies for use with ANSI Class 300 flanges are available on special order.

- **R-Series valves are designed for use with standard weight or schedule 40 pipe inside dimensions. Check data sheets for specific clearance dimensions.**

If heavy wall, plastic or cement lined pipe is used, back beveling at the flange may be required for disc clearance.

2" – 12" Norris Butterfly Valves Parts Description

1. **Body** – Valve body isolated from flow stream by resilient seat and o-ring seals. Steel bodies have Teflon bushings to prevent seizing with stainless steel shafts. Three different models and six materials are available. See exploded assembly.
2. **Disc** – Angle disc construction gives 360° uninterrupted contact of disc with seat. Disc does not seat in shaft holes, assuring bubble-tight shutoff time after time with no scrubbing of the elastomer in the shaft hole areas. Disc drive slot assures positive disc action. Precision fit prevents disc "flutter"
3. **Operating Shaft** – Operating shaft is retained by a sealed retention screw for safety. Shaft is double o-ring sealed to prevent leakage into shaft bearing areas and protect from outside contamination. Milled drive flats are parallel to disc, indicate disc position.

- **4. Bottom Shaft** – Stationary bottom shaft is double o-ring sealed to prevent stem leakage.
- **5. Seat** – Field replaceable resilient seat is bonded to a rigid backing ring to prevent seat from distorting or collapsing due to high velocity flow or in vacuum service. Rigid backing also prevents seat collapse during installation of valve between flanges.
- **6. Body O-rings** – Body o-ring flange seals eliminate need for flange gaskets. Flange seals can be replaced without dismantling the valve and replacing the seat. Many times a damaged o-ring flange seal can be repaired simply by turning it over and returning it to the body face groove.
- **7-8. O-ring Shaft Seals** – Shaft seals prevent leakage to atmosphere and permanently lubricated areas; protect from outside contamination.
- **10-11. Steel & Teflon Thrust Washers** – Provide precision fit with topworks. Eliminates “disc flutter.”
- **12-13. Bottom Plate & Capscrews** – Bottom shaft is retained by a thrust plate and retention screw.
- **14-15. Capscrew & Washer** – Top shaft is retained by sealed retention screw for safety. Cannot be removed when valve is installed between flanges.

14” – 36” Norris Butterfly Valves Parts Description

- **1. Body** – Valve body isolated from flow stream by resilient seat and o-ring seals. All 14” and larger bodies have inboard and outboard shaft bushings for handling shaft loads and to provide minimum operating torque. Two models, 3 materials are available.
- **2. Disc** – Angle disc construction gives 360° uninterrupted contact of disc with seat. Disc does not seat in shaft holes, assuring bubble-tight shutoff time after time with no scrubbing of the elastomer in the shaft hole areas.
- **3. Shaft** – Through shaft, cross pinned to disc with straight dowel pin, assures maximum drive strength and field repairability. Disc pin does not penetrate the sealing plane of the disc.

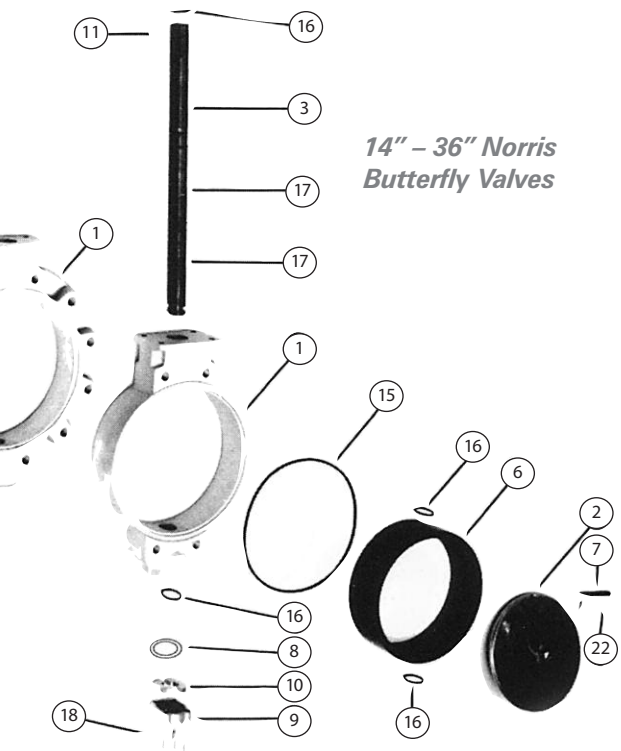

14” – 36” Norris
Butterfly Valves

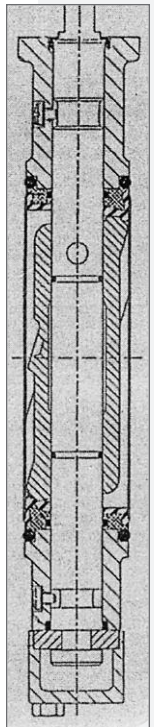

- **6. Seat** – Field replaceable resilient seat is bonded to a rigid backing ring to prevent seat from distorting or collapsing due to high velocity flow or in vacuum service. Rigid backing also prevents seat collapse during installation of valve between flanges.
- **7. Disc Pin** – Disc pin does not penetrate the sealing plane of the disc.
- **8. Shim Set** – Assures proper disc support and centering in seating area.
- **9-10. Thrust Plate & Washer** – Retains shaft from bottom.
- **11. Key** – Provides precision fit with operator.
- **15. Body O-rings** – Body o-ring flange seals eliminate need for flange gaskets. Flange seals can be replaced without dismantling the valve and replacing the seat. Many times a damaged o-ring flange seal can be repaired simply by turning it over and returning it to the body.
- **16. O-ring Seat and Shaft Seals** – Seat and shaft seals prevent stem leakage to atmosphere and permanently lubricated areas; protect from outside contamination.
- **17. O-ring Disc/Shaft Seals** – Seals prevent leakage across disc plane. Patented Teflon seal available.
- **18. Thrust Plate Capscrews** – To retain bottom thrust plate.
- **22. Disc Pin Capscrews** – To retain disc pin.



When to use Series M-200 Valves

- **Use M-Series valves for positive shutoff to 200 psi wp.**
Under certain service conditions, Norris valves may be rated up to 250 psi wp. Consult factory for trim recommendations and pricing.
- **Use M-Series valves for throttling control when flow rates do not exceed 16 fps.**
- **Use M-Series valves at temperatures from -40° to +350°F.**
Proper selection of seal elastomers must be made for valve applications at extreme temperatures.
- **Use M-Series valves of any size for complete bi-directional, zero bubble positive shutoff. A wide range of elastomer or teflon seals are available.**
- **Use M-Series valves for controlling the flow of liquids and gases, including abrasive and corrosive materials.**
Limited use of elastomers in M-Series valves make them ideal for handling gasolines and other volatile media which tend to dry the elastomer. Field replaceable metal seat is available in a variety of exotic materials to resist corrosion. Metal seat liner and double o-ring shaft seals prevent line media from contacting body of valve, making use of premium body materials unnecessary. Only the internal wetted parts need to be corrosion resistant to the media. M-Series valves are not recommended for use when large abrasive material is present. See R-Series section.
- **Use M-Series lug-type valves for end-of-line suspension to full rated working pressure without a downstream flange or spool piece.**
- **Use M-Series valves for insulated lines.**
14 inch and larger Norris valves will accommodate 2 inches of insulation on accompanying pipelines. A neck extender is available for use with 2 thru 12 inch wafer valves when lines are insulated.
- **Use M-Series valves with ANSI Class 125 cast iron or Class 150 steel flanges. Care should be exercised to assure that valve body is correctly centered when installing M-Series valves between slip on flanges.**
M-Series span type valves can be used with ANSI Class 300 flanges, however, some valve sizes may require special bolt drilling or spacers.

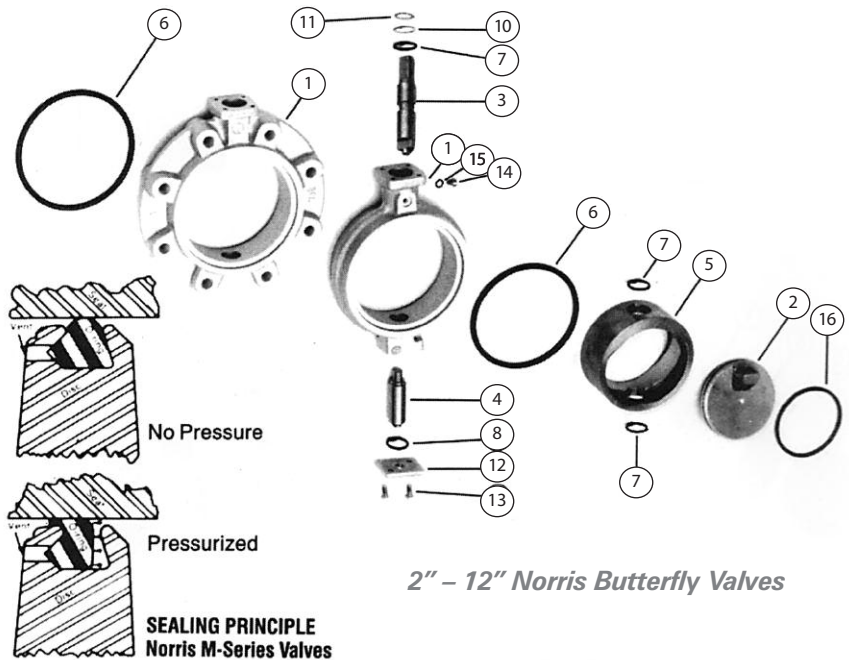

2" – 12" Norris Butterfly Valves

Lug style bodies for use with ANSI Class 300 flanges are available on special order. (Consult factory).

- **M-Series valves are designed for use with standard weight or schedule 40 pipe inside dimensions. Check data sheets for specific clearance dimensions.**

If heavy wall, plastic or cement lined pipe is used, back beveling at the flange may be required for disc clearance.

- **Norris M-Series butterfly valves have been found to offer maximum resistance to damage from fire because of limited use of elastomers in the sealing design. (Request fire test report for specifics).**

2" – 12" Norris Butterfly Valves Parts Description

- **1. Body** – Valve body isolated from flow stream by metal seat and o-ring seals. Steel bodies have Teflon bushings to prevent seizing with stainless steel shafts. Three different models and six materials are available. See exploded assembly.
- **2. Disc.** Angle disc construction gives 360° uninterrupted contact of disc o-ring with seat for dependable bubble-tight shutoff. Drive slot assures positive disc action. Precision fit prevents disc "flutter."
- **3. Operating Shaft.** Operating shaft is retained by a sealed retention screw for safety. Shaft is double o-ring sealed to prevent leakage into shaft bearing areas and protect from outside

contamination. Milled drive flats are parallel to disc and indicate disc position.

- **4. Bottom Shaft.** Stationary bottom shaft is double o-ring sealed to prevent stem leakage.
- **5. Seat.** Field replaceable metal seat isolates valve body from flow stream and eliminates need for premium body material.
- **6. Body O-rings.** Body o-ring flange seals eliminate need for flange gaskets. Flange seals can be replaced without dismantling the valve and replacing the seat. Many times a damaged o-ring flange seal can be repaired simply by returning it to the body face groove.
- **7/8. O-ring Shaft Seals.** Shaft seals prevent leakage to atmosphere and permanently lubricated areas; protect from outside contamination.
- **10/11. Steel & Teflon Thrust Washers.** Provide precision fit with topworks. Eliminates "disc flutter."
- **12/13. Bottom Plate & Capscrews.** Bottom shaft is retained by a thrust plate.
- **14/15. Capscrew & Washer.** Top and bottom shafts are retained by sealed retention screws for safety. Cannot be removed when valve is installed between flanges.
- **16. Disc O-ring Seal.** Pressure energized o-ring seal contained in specially designed groove in disc edge assures positive shutoff. The higher the pressure the tighter the seal.

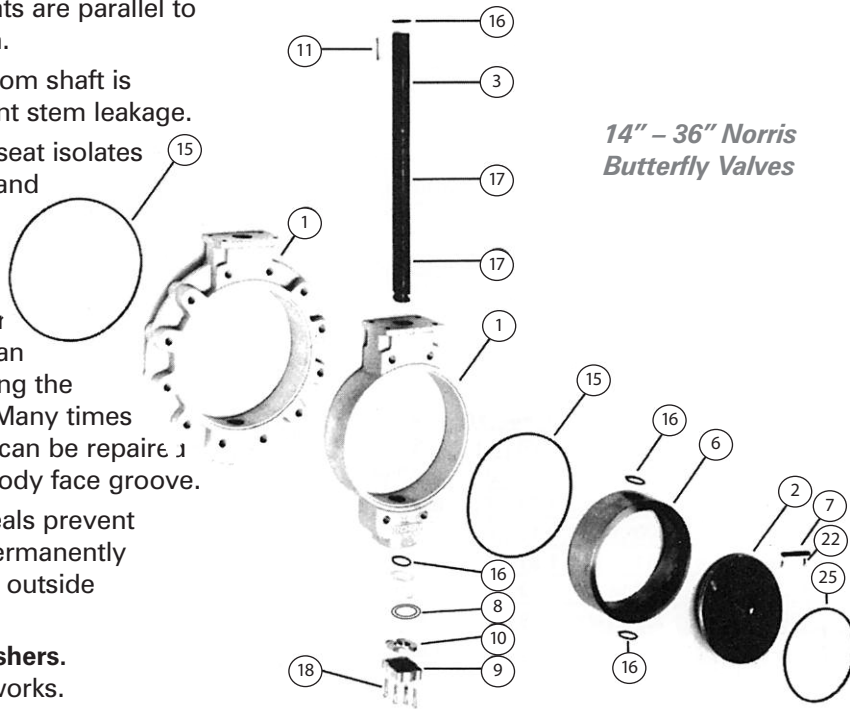

14" – 36" Norris Butterfly Valves

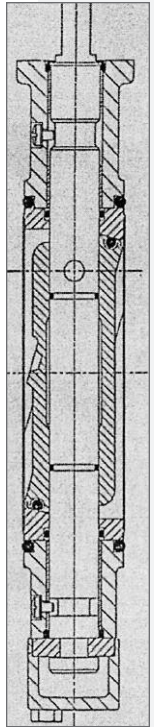

14" – 36" Norris Butterfly Valves Parts Description

- **1. Body** – Valve body isolated from flow stream by metal seat and o-ring seals. All 14" and larger bodies have inboard and outboard bushings for handling shaft loads and to provide minimum torque. Two models, three materials are available.
- **2. Disc** – Angle disc construction gives 360° uninterrupted contact of disc o-ring with seat for dependable bubble-tight shutoff.
- **3. Shaft** – Through shaft, cross pinned to disc with straight dowel pin, assures maximum drive strength and field repairability. Disc pin does not penetrate sealing plane of the disc.
- **6. Seat** – Field replaceable metal seat isolates valve body from flow stream; eliminates need for premium body material.
- **7. Disc Pin** – Disc pin does not penetrate the sealing plane of the disc.
- **8. Shim Set** – Assures proper disc support and centering in seating area.
- **9-10. Thrust Plate & Washer** – Retains shaft from bottom.
- **11. Key** – Provides precision fit with operator.
- **15. Body O-rings** – Body o-ring flange seals eliminate need for flange gaskets. Flange seals can be replaced without dismantling the valve and replacing the seat. Many times a damaged o-ring flange seal can be repaired simply by turning it over and returning it to the body face groove.
- **16. O-ring Seat and Shaft Seals** – Seat and shaft seals prevent stem leakage to atmosphere and permanently lubricated areas; protect from outside contamination.
- **17. O-ring Disc/Shaft Seals** – Seals prevent leakage across disc plane. Patented Teflon seal available.
- **18. Thrust Plate Capscrews** – To retain bottom thrust plate.
- **22. Disc Pin Capscrews** – To retain disc pin.
- **25. Disc O-ring Seal** – Pressure energized o-ring seal contained in a specially designed groove in disc edge assures positive shutoff. The higher the pressure the tighter the seal.

R&M-1000 2"-12" Valves

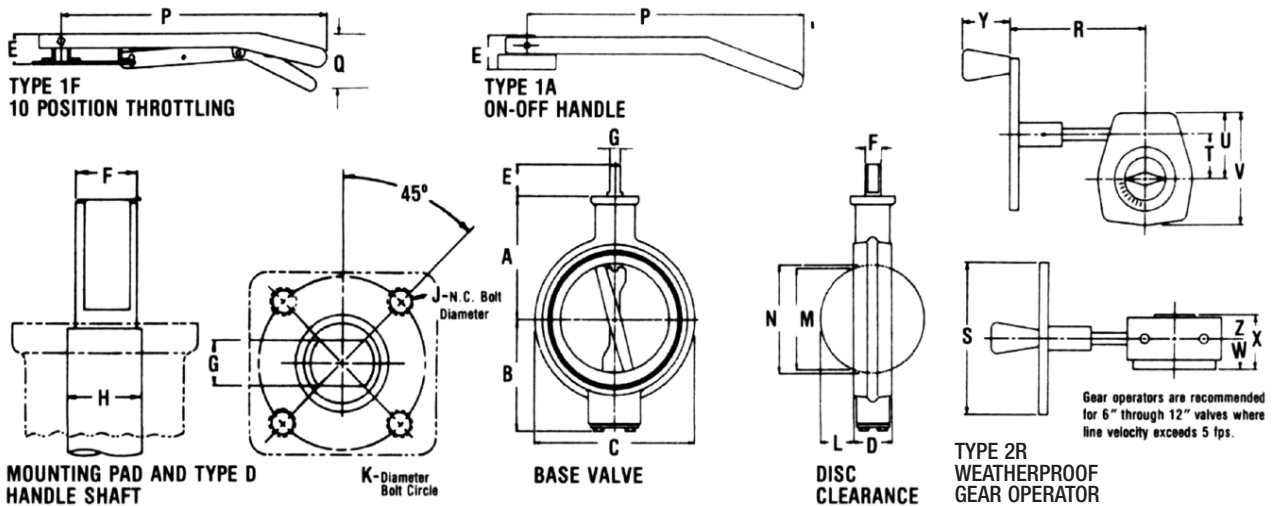

VALVE DIMENSIONS

Dimension Reference	Valve Size (Inches/mm)									
	2/50	2.5/65	3/75	3.5/90	4/100	5/125	6/150	8/200	10/250	12/300
A	3.70	4.16	4.41	N/A	4.88	5.28	6.50	7.47	9.38	10.41
B	3.22	3.75	4.05	N/A	4.50	4.91	6.00	6.94	8.66	9.69
C	4.13	4.88	5.38	N/A	6.88	7.75	8.75	10.88	13.38	16.00
D	1.63	1.75	1.75	N/A	2.00	2.14	2.13	2.50	2.50	3.00
E	1.31	1.31	1.31	N/A	1.31	1.31	1.69	1.69	2.00	2.00
F	.69	.69	.69	N/A	.69	.69	.88	.88	1.06	1.06
G	.50	.50	.50	N/A	.50	.50	.63	.63	.75	.75
H	.69	.88	.88	N/A	.88	.88	1.06	1.06	1.38	1.38
J	.25	.25	.25	N/A	.25	.25	.38	.38	.38	.38
K	1.81	1.81	1.81	N/A	1.81	1.81	2.34	2.34	2.63	2.63

DISC CLEARANCE

L	.38	.50	.75	N/A	1.13	1.56	1.94	2.69	3.75	4.50
M	1.77	2.06	2.69	N/A	3.59	4.72	5.55	7.44	9.58	11.52
N	2.41	2.72	3.20	N/A	4.19	5.17	5.91	7.81	9.89	11.89
Approx Wt. (lbs) Cast Iron Body	5	7	9	-	14	17	23	37	59	80

BOLT DATA

For Use with ANSI Class 150 Weldneck Flanges. For optimum valve performance, it is recommended that butterfly valves be installed between weldneck flanges or flanges with equivalent inside dimensions.										
Bolt Size	.63 x 4.00	.63 x 4.50	.63 x 4.50	N/A	.63 x 4.50	.75 x 5.50	.75 x 5.50	.75 x 6.00	.88 x 6.00	.88 x 7.00
No. Required	4	4	4	-	8	8	8	8	12	12

OPERATOR DIMENSIONS

P	9.94	9.94	9.94	N/A	9.94	9.94	9.94	9.94	16.00	16.00
Q	3.34	3.34	3.34	N/A	3.34	3.34	3.00	3.00	3.66	3.66
R	6.88	6.88	6.88	N/A	6.88	6.88	7.50	7.50	8.00	8.00
S	6.00	6.00	6.00	N/A	6.00	6.00	8.00	8.00	8.00	8.00
T	2.36	2.36	2.36	N/A	2.36	2.36	2.36	2.36	3.00	3.00
U	3.50	3.50	3.50	N/A	3.50	3.50	3.50	3.50	4.38	4.38
V	5.93	5.93	5.93	N/A	5.93	5.93	5.93	5.93	7.50	7.50
W	5.25	5.25	5.25	N/A	5.25	5.25	5.25	5.25	6.75	6.75
X	2.92	2.92	2.92	N/A	2.92	2.92	2.92	2.92	3.27	3.27
Y	2.63	2.63	2.63	N/A	2.63	2.63	2.63	2.63	2.63	2.63
Z	1.69	1.69	1.69	N/A	1.69	1.69	1.69	1.69	1.88	1.88
Approx Wt. (lbs) 2R & 2RM Operator	7	7	7	N/A	7	7	8	8	13	13

R&M-1000 14"-36" Valves

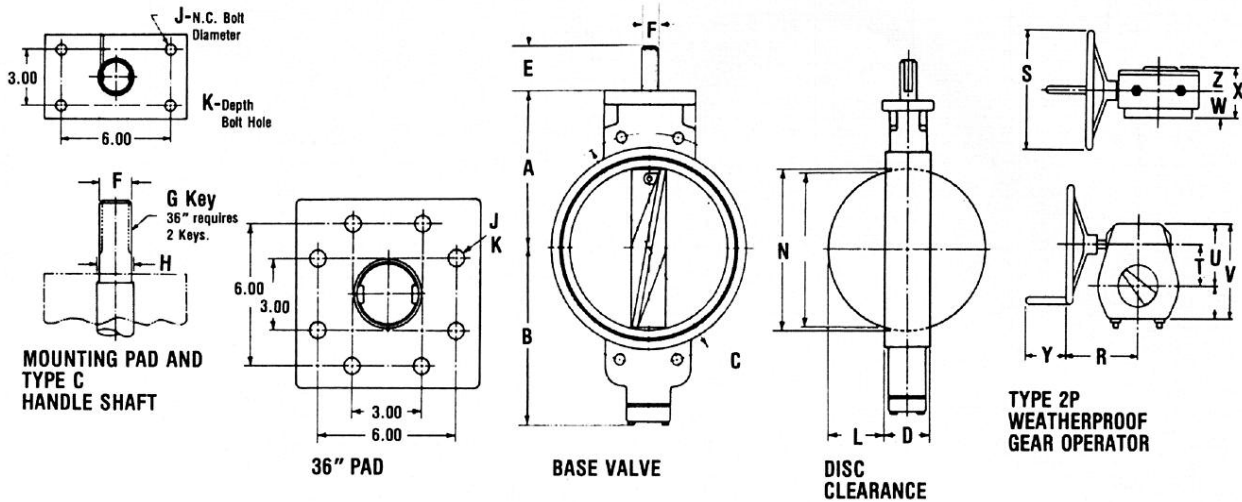

VALVE DIMENSIONS

Dimension Reference	Valve Size (Inches/mm)										
	14/350	16/400	18/450	20/500	22/550	24/600	26/650	28/700	30/750	32/800	36/900
A	12.63	14.00	14.75	16.00	17.38	17.50	20.13	22.75	23.75	24.50	26.13
B	14.25	15.63	16.63	17.88	18.00	19.00	20.61	21.83	22.70	24.23	29.38
C	18.75	21.25	22.75	25.00	27.25	29.50	31.75	34.00	36.00	38.50	42.75
D	3.75	4.13	4.63	5.13	5.00	5.00	6.00	6.50	7.00	7.00	8.50
E	3.94	3.94	3.94	3.94	3.94	3.94	3.94	3.94	3.94	3.94	4.75
F	1.75	1.75	1.75	2.50	2.50	2.50	2.50	2.50	2.50	2.50	3.00
G	.38x2.5	.38x2.5	.38x2.5	.63x2.94	.63x2.94	.63x2.94	.63x2.94	.63x2.94	.63x2.94	.63x2.94	.75x3.0
H	1.75	2.00	2.25	2.50	2.50	2.50	3.00	3.00	3.00	3.50	3.50
J	.63	.63	.63	.63	.63	.63	.75	.75	.75	.75	.75
K	1.50	1.50	1.50	1.50	1.50	1.50	1.50	1.50	1.50	1.50	1.50

DISC CLEARANCE

L	4.79	5.61	6.36	7.14	8.19	9.19	9.60	10.36	11.10	11.96	12.88
M	12.80	14.78	16.72	18.72	20.75	22.83	24.50	26.38	28.50	30.13	34.25
N	13.34	15.34	17.34	19.41	21.33	23.38	25.51	27.21	29.21	30.96	35.25
Approx Wt. (lbs) Cast Iron Body	187	262	351	432	550	606	790	910	1160	1220	1840

BOLT DATA

For Use with ANSI Class 150 Weldneck Flanges.
For optimum valve performance, it is recommended that butterfly valves be installed between weldneck flanges or flanges with equivalent inside dimensions.

Bolt Size	1.00x 7.75	1.00x 8.50	1.13x 9.00	1.13x 10.00	1.25x 11.50	1.25x 11.50	1.25x 13.00	1.25x 13.50	1.25x 14.00	1.50x 14.00	1.50x 15.00
No. Required (Both Required)	8	12	12	16	16	16	20	24	24	24	28
Capscrew Size	1.00NCx3.00	1.00NCx3.00	1.13NCx3.00	1.13NCx3.00	1.25NCx4.00	1.25NCx4.00	1.25NCx3.50	1.25NCx3.25	1.25NCx3.50	1.50NCx3.75	1.50NCx3.75
No. Required	8	8	8	8	8	8	8	8	8	8	8

OPERATOR DIMENSIONS

R	9.75	9.75	9.75	17.25	17.25	17.25	17.84	17.84	17.84	17.84	17.84
S	12.75	12.75	12.75	24.00	24.00	24.00	24.00	24.00	24.00	24.00	24.00
T	4.83	4.83	4.83	5.38	5.38	5.38	2.69	2.69	2.69	2.69	7.13
U	6.63	6.63	6.63	7.63	7.63	7.63	9.44	9.44	9.44	9.44	10.81
V	10.13	10.13	10.13	11.13	11.13	11.13	14.94	14.94	14.94	14.94	16.31
W	9.00	9.00	9.00	10.81	10.81	10.81	12.00	12.00	12.00	12.00	14.00
X	5.00	5.00	5.00	5.14	5.14	5.14	7.38	7.38	7.38	7.38	7.75
Y	4.50	4.50	4.50	N/A	N/A	N/A	N/A	N/A	N/A	N/A	N/A
Z	2.88	2.88	2.88	2.88	2.88	2.88	4.00	4.00	4.00	4.00	4.00
Approx Wt. (lbs) 2R & 2RM Operator	70	70	70	90	90	90	90	210	210	210	260

R&M-3000 2"-12" Valves

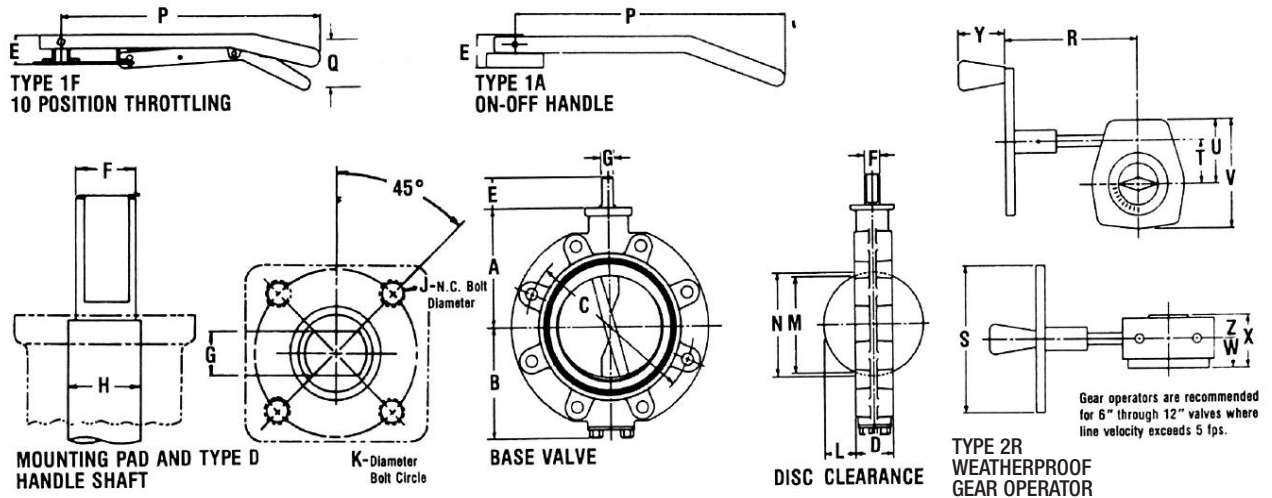

VALVE DIMENSIONS

Dimension Reference	Valve Size (Inches/mm)									
	2.50	2.5/65	3/75	3.5/90	4/100	5/125	6/150	8/200	10/250	12/300
A	3.70	4.16	4.41	4.63	4.88	5.28	6.50	7.47	9.38	10.41
B	3.22	3.75	4.05	4.25	4.50	4.91	6.00	6.94	8.66	9.69
C	4.75	5.50	6.00	7.00	7.50	8.50	9.50	11.75	14.25	17.00
D	1.63	1.75	1.75	1.94	2.00	2.13	2.13	2.50	2.50	3.00
E	1.31	1.31	1.31	N/A	1.31	1.31	1.69	1.69	2.00	2.00
F	.69	.69	.69	.69	.69	.69	.88	.88	1.06	1.06
G	.50	.50	.50	.50	.50	.50	.63	.63	.75	.75
H	.69	.88	.88	.88	.88	.88	1.06	1.06	1.38	1.38
J	.25	.25	.25	.25	.25	.25	.38	.38	.38	.38
K	1.81	1.81	1.81	1.81	1.81	1.81	2.34	2.34	2.63	2.63

DISC CLEARANCE

L	.38	.50	.75	.94	1.13	1.56	1.94	2.69	3.75	4.50
M	1.77	2.06	2.69	3.16	3.59	4.72	5.55	7.44	9.58	11.52
N	2.41	2.72	3.20	3.72	4.19	5.17	5.91	7.81	9.89	11.89
Approx Wt.- Cast Iron Body	7	9	11	14	18	22	30	44	68	108

BOLT DATA

For Use with ANSI Class 150 Weldneck Flanges. For optimum valve performance, it is recommended that butterfly valves be installed between weldneck flanges or flanges with equivalent inside dimensions.										
Capscrew Size	.63NC x 1.50	.63NC x 1.50	.63NC x 1.75	.63NC x 1.75	.63NC x 1.75	.75NC x 1.75	.75NC x 2.00	.75NC x 2.25	.88NC x 2.25	.88NC x 2.50
No. Required	8	8	8	16	16	16	16	16	24	24

*Through-tapped from face to face for studs or capscrews unless specified otherwise.

OPERATOR DIMENSIONS

P	9.94	9.94	9.94	N/A	9.94	9.94	9.94	9.94	16.00	16.00
Q	3.34	3.34	3.34	N/A	3.34	3.34	3.00	3.00	3.66	3.66
R	6.88	6.88	6.88	N/A	6.88	6.88	7.50	7.50	8.00	8.00
S	6.00	6.00	6.00	N/A	6.00	6.00	8.00	8.00	8.00	8.00
T	2.36	2.36	2.36	N/A	2.36	2.36	2.36	2.36	3.00	3.00
U	3.50	3.50	3.50	N/A	3.50	3.50	3.50	3.50	4.38	4.38
V	5.93	5.93	5.93	N/A	5.93	5.93	5.93	5.93	7.50	7.50
W	5.25	5.25	5.25	N/A	5.25	5.25	5.25	5.25	6.75	6.75
X	2.92	2.92	2.92	N/A	2.92	2.92	2.92	2.92	3.27	3.27
Y	2.63	2.63	2.63	N/A	2.63	2.63	2.63	2.63	2.63	2.63
Z	1.69	1.69	1.69	N/A	1.69	1.69	1.69	1.69	1.88	1.88
Aprox Wt. 2M & 2RM Operator	7	7	7	N/A	7	7	8	8	13	13

R&M-3000 14"-36" Valves

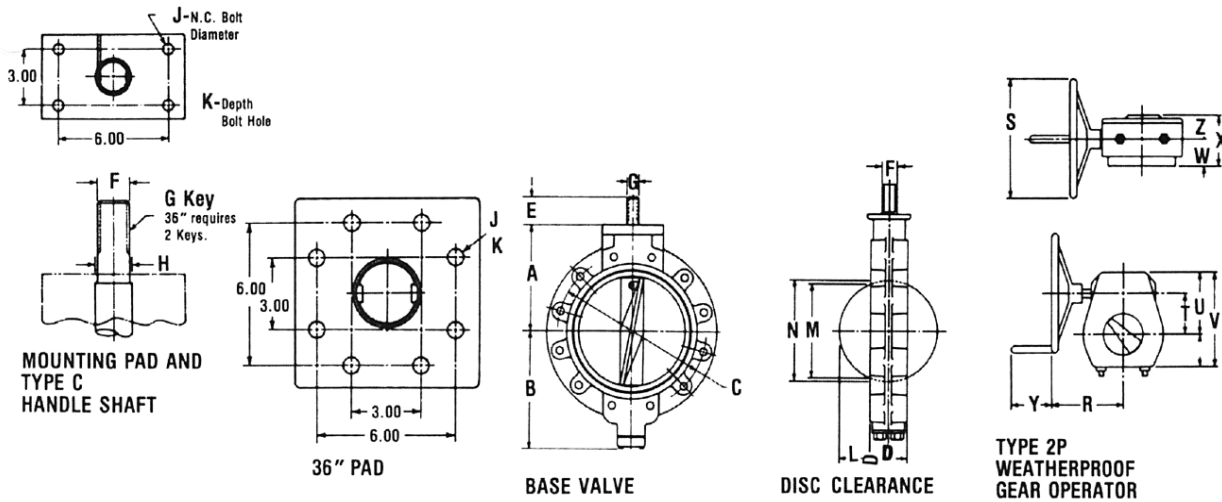

VALVE DIMENSIONS

Dimension Reference	Valve Size (Inches/mm)										
	14/350	16/400	18/450	20/500	22/550	24/600	26/650	28/700	30/750	32/800	36/900
A	12.63	14.00	14.75	16.00	17.38	17.50	20.13	22.75	23.75	24.50	26.13
B	14.25	15.63	16.63	17.88	18.00	19.00	20.61	21.83	22.70	24.23	29.38
C	18.75	21.25	22.75	25.00	27.25	29.50	31.75	34.00	36.00	38.50	42.75
D	3.75	4.13	4.63	5.13	5.00	5.00	6.00	6.50	7.00	7.00	8.50
E	3.94	3.94	3.94	3.94	3.94	3.94	3.94	3.94	3.94	3.94	4.75
F	1.75	1.75	1.75	2.50	2.50	2.50	2.50	2.50	2.50	2.50	3.00
G	.38x2.5	.38x2.5	.38x2.5	.63x2.94	.63x2.94	.63x2.94	.63x2.94	.63x2.94	.63x2.94	.63x2.94	.75x3.0
H	1.75	2.00	2.25	2.50	2.50	2.50	3.00	3.00	3.00	3.50	3.50
J	.63	.63	.63	.63	.63	.63	.75	.75	.75	.75	.75
K	1.50	1.50	1.50	1.50	1.50	1.50	1.50	1.50	1.50	1.50	1.50

DISC CLEARANCE

L	4.79	5.61	6.36	7.14	8.19	9.19	9.60	10.36	11.10	11.96	12.88
M	12.80	14.78	16.72	18.72	20.75	22.83	24.50	26.38	28.50	30.13	34.25
N	13.34	15.34	17.34	19.41	21.33	23.38	25.51	27.21	29.21	30.96	35.25
Approx Wt.- Cast Iron Body	234	339	432	538	590	621	960	1150	1300	1360	2150

BOLT DATA

For Use with ANSI Class 150 Weldneck Flanges.
For optimum valve performance, it is recommended that butterfly valves be installed between weldneck flanges or flanges with equivalent inside dimensions.

Capscrew Size	1.00NCx3.00	1.00NCx3.00	1.13NCx3.50	1.13NCx3.50	1.25NCx4.00	1.25NCx4.00	1.25NCx4.00	1.25NCx4.00	1.25NCx4.00	1.50NCx4.50	1.50NCx4.50
No. Required (Both Required)	24	32	32	32	32	40	40	48	48	48	64
Capscrew Size				1.13NCx3.00	1.25NCx3.50		1.25NCx3.50	1.25NCx3.25	1.25NCx3.50	1.25NCx3.75	1.50NCx4.00
No. Required	N/A	N/A	N/A	8	8	N/A	8	8	8	8	8

OPERATOR DIMENSIONS

R	9.75	9.75	9.75	17.25	17.25	17.25	17.84	17.84	17.84	17.84	17.84
S	12.75	12.75	12.75	24.00	24.00	24.00	24.00	24.00	24.00	24.00	24.00
T	4.83	4.83	4.83	5.38	5.38	5.38	2.69	2.69	2.69	2.69	7.13
U	6.63	6.63	6.63	7.63	7.63	7.63	9.44	9.44	9.44	9.44	10.81
V	10.13	10.13	10.13	11.13	11.13	11.13	14.94	14.94	14.94	14.94	16.31
W	9.00	9.00	9.00	10.81	10.81	10.81	12.00	12.00	12.00	12.00	14.00
X	5.00	5.00	5.00	5.14	5.14	5.14	7.38	7.38	7.38	7.38	7.75
Y	4.50	4.50	4.50	N/A	N/A	N/A	N/A	N/A	N/A	N/A	N/A
Z	2.88	2.88	2.88	2.88	2.88	2.88	4.00	4.00	4.00	4.00	4.00
Approx Wt. 2P & 2PM Operator	70	70	70	90	90	90	90	210	210	210	260

Valve Model Number System 200 WP

VALVE CONFIGURATION	
Configuration	Code
Special to be Described	00
Span Wafer Body	10
(1.50"-12) Double Rib Span Wafer Body. 200WP	20
Full Tapped Lug Body	30

SERIES	
Series	Code
Resilient Seat	R
Metal Seat	M
Metal-to-Metal Seat (Damper Style)	D

VALVE SIZE (IN INCHES)	
Size	Code
2" - 36"	2...36

BODY MATERIALS	
Material Type	Code
Ductile Iron ASTM A395 60-40-18	11
(WCB) Cast Steel ASTM A216 GR WCB	20
(3) Stainless Steel, ASTM A743 CF-8M*	21
Alloy 20, ASTM A743 GR CN7M	22
(L) Valve Bronze, ASTM B61	30
(FK) NI-CU-AL Bronze ASTM B148, Alloy C95800	31
(A) Aluminum Alloy 356T6 ASTM B26 Alloy 5G70A	40

*Special Order - Consult Factory

SHAFT MATERIAL	
Material	Code
(C) Ductile Iron, ASTM B473 UNS N08020	1
(3) Stainless Steel ASTM A276, Type 316	2
(F) Stainless Steel ASTM A276, Type 416	3
(M) Nickel-Copper Alloy (Monel) ASTM B164 Class A	4
(EN) Nitronic 50	5
(K) NI-CU-AL Alloy QQ-N-286A (K-Monel)*	6
(AP) Stainless Steel 17-4PH ASTM A564 Type 630	7
(W) Inconel 600	8
(AJ) Titanium ASTM B348 GR 4	9
() Special to be Described	0
(BH) Hastelloy B, ASTM B335	B
(AM) Hastelloy C, ASTM B574 Alloy N102:76	C
(EB) Zirconium	F

*K-Monel std. in 22" & Larger Valves with Monel Shaft

DISC MATERIAL	
Code	Materials
1	(D) Ductile Iron, ASTM A395 60-40-18
2	(3) Stainless Steel 316 ASTM A743 GR CF-8M
3	(C) Alloy 20 ASTM A743 GR CN-7M
4	(AL) ASTM B148 C95500
5	(A) Aluminum Alloy 356T6 ASTM B26 Alloy
6	(M) Nickel-Copper Alloy (Monel) ASTM A494, M30C
9	(AJ) Titanium ASTM B367 GR8A
0	() Special to be described
B	(BH) Hastelloy B, ASTM A494
C	(AM) Hastelloy C, ASTM A494 CW 12-MW
G	(W) Inconel 600 ASTM A494 Alloy CY-40
K	(EA) Illium PD
P	(FK) NI-CU-AL Bronze ASTM B148 Alloy C98500

SEAT MATERIAL	
Code	Seat R Series
A	Buna N
B	Fluoroelastomer (Viton)
B2	Viton GF/Epoxy Backing
B3	Fluoroelastomer/Epoxy Backing
D	TFE Impregnated Fluoroelastomer
E	Neoprene (Black)
E2	Neoprene (Epoxy Backing)
G	Neoprene (White)
J	Nitrile, Abrasive Resistant
N	Natural Rubber
S	EPDM, Peroxide Cured
4	HSN, Highly Saturated Nitrile/ Epoxy Backing
5	Natural Red Rubber
8	Peroxide Cured Nitrile

Code	Seat M Series
1	(G) Cast Iron, ASTM A126 Class B
2	(3) Stainless Steel 316 ASTM A743 GR CF-8M
3	(AB) Aluminum Bronze ASTM B148 Alloy C95300
4	(A) Aluminum Alloy 356T6 ASTM B26 Alloy SG70A
5	(M) NI CU Alloy (Monel) ASTM A494, M30C
6	(W) Inconel No. 610
7	(C) Stainless Steel Alloy 20 ASTM A743 GR CN7M
9	(AJ) Titanium ASTM B367 GR8A
0	() Special to be described
B	(BH) Hastelloy B, ASTM A494 N-12MV
C	(AM) Hastelloy C, ASTM A494 CW 12-MW
D	(EB) Zirconium
F	(EA) Illium PD
G	(FK) NI-CU-AL Bronze ASTM B148 Alloy C95800

6 M 30 11 - 4 2 3 BAA - 2R

SEALS	
Materials	Code
Buna N	A
Fluoroelastomer	B
Fluorosilicone	C
PTFE Impregnated Fluoroelastomer	D
Neoprene (Black)	E
Neoprene (White)	G
Nitrile (Low Temp)	M
Natural Rubber	N
AFLAS	R
EPDM	S
Low Temp Neoprene	V
Kalrez	Y
Zalak	Z
Highly Saturated Nitrile	4
Peroxide Cured Nitrile	8
TFE/SIL	9A

NORRIS OPERATORS

Code	Manual Operators
1A	(1.5-12) STD Handle with 1J Topworks
1F	(2-12) Squeeze Trigger 10 Pos
1FM	(1.5-12) 1F with Marine Trim
1J	(2-12) STD Topworks On-Off
1AM	(2-5) STD Handle with 1S Topworks
1P	(2-8) Locking Topworks
1Q	(2-5) 1P Topworks with STD Handle
1JS	(2-8) STD On-Off Topworks, Stainless Steel

Code	Mechanical Operators
2E	(2-12) Gear - W.P. - Aluminum Bronze Marine Trim
2ES	(2-12) 2E Subm. for Salt Water
2R	(2-12) Gear Operator Aluminum Case
2T	(2-36) Gear Operator Cast Iron Case
2RM	2R with Marine Trim
2TM	2T with Marine Trim

Code	Diaphragm Operators
**	
2G11	(2-4) 35 SR Diaphragm Actuator
2G12	(2-4) 35 PB Diaphragm Actuator
2G13	(2-8) 70 SR Diaphragm Actuator
2G14	(2-8) 70 PB Diaphragm Actuator
2G15	(6-12) 180A SR Diaphragm Actuator
2G16	(6-12) 180 PB Diaphragm Actuator
2G17	(12-20) 180 SR Diaphragm Actuator
2G18	(12-20) 180 PB Diaphragm Actuator

**2G Numbers listed are Basic Numbers Only. Complete Actuator Model Number Must be Used when ordering.

SR - Spring Return. Specify Fail/Open or Fail/Closed.

PB - Pressure Balanced/Double Acting.

Please note: not all available options are shown.

Typical Specifications, General Purpose Trim

Valves 2" through 36" shall be resilient lined wafer-lug butterfly type with replaceable body o-ring flange seals. Bodies shall be of high-strength ductile iron with aluminum bronze discs, 416 stainless steel shafts, aluminum bronze seats and Buna N (Hycar®) seats and seals. *For more severe applications, consult trim table for proper body, disc, shaft, seal and o-ring material selection.* Valves through 5" shall have lever handles for

on-off service *or other specified operator.* Valves 6" and larger shall be equipped with weatherproof gear operators *or other specified operator.* Valves shall be suitable for installation between ANSI Class 150 weldneck flanges or other specified flanges without special preparation. Butterfly valves shall be Norris Angle, Disc Model R2011 – 43AA-1A *or other specified model number.*

M200 Series Specifications

Typical Specifications, General Purpose Trim

Valves 2" through 36" shall be metal lined wafer-lug butterfly type. Bodies shall be of high-strength cast iron with aluminum bronze discs, 416 stainless steel shafts, aluminum bronze seats and Buna N (Hycar®) seats and seals. *For more severe applications, consult trim table, above, for proper body, disc, shaft, seal and o-ring material selection.* Valves through 5" shall have lever handles for

on-off service *or other specified operator.* Valves 6" and larger shall be equipped with weatherproof gear operators *or other specified operator.* Valves shall be suitable for installation between ANSI Class 150 weldneck flanges or other specified flanges without special preparation. Butterfly valves shall be Norris Angle, Disc Model M1011 – 433A *or other specified model number.*

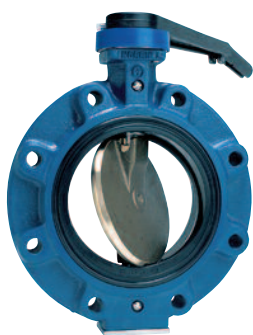

Series R200



Series M200

When Experience Counts in the Field, We're Close at Hand

Norris provides service through a domestic and international distribution network. We also maintain a staff of well-trained field representatives who are strategically located to serve you better.

Why you can depend on genuine Norriseal products

- In-house engineering and technical support
- In-depth applications experience
- Award-winning innovation and ongoing product development
- ISO 9001-certified manufacturing
- Over five decades of industry service
- Compliance with all industry standards and specifications
- Responsive service and prompt delivery
- Field support available worldwide

Please contact your Norriseal representative for more details and assistance in specifying the optimal solution for your application.



Engineered Performance

11122 West Little York • Houston, Texas 77041

Tel: 713-466-3552 • Fax: 713-896-7386

www.norriseal.com

Due to the continuous improvement program at Norriseal, specifications and/or prices are subject to change without notice or obligation. Envirosave is a mark of Norriseal, A Dover Company. All other trademarks contained herein are the property of their respective owners.

© 2012 Norriseal, A Dover Company

200-0312T